

Touch PRO

Carwash multi-device

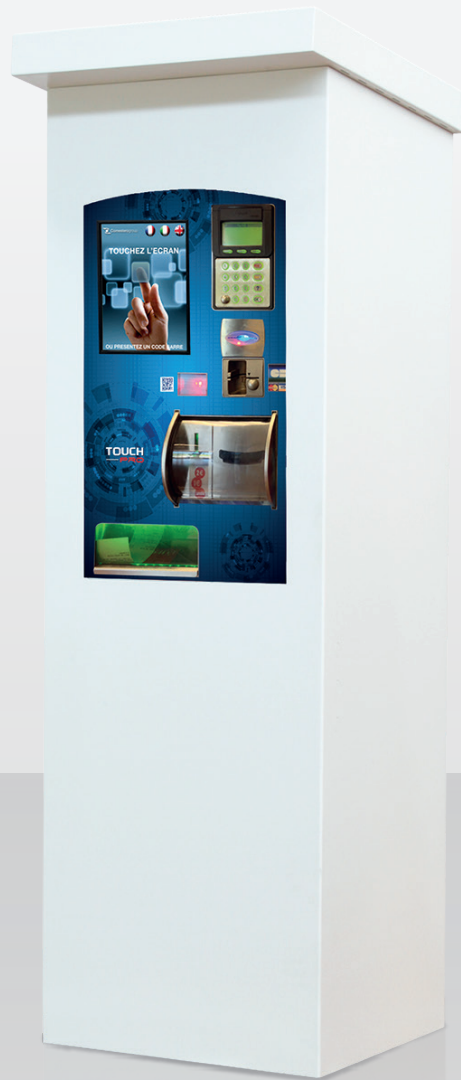

A truly automated car wash service
support and a powerful marketing tool

The best technology blends together with ease of use and profitability

Its state of the art technology offers numerous advantages to both the user and the operator. Its practical, wide anti-vandal touch screen and payment systems are grouped together to be immediately recognisable and give accessible result in greater ease of use. It manages up to 8 different services and dispense complementary products, such as tokens and cards.

Features

- User friendly touch screen interface for easy sales operations as well as accounting data configuration and collection
- Graphic and vocal support guiding the user through various operations
- Possibility to pay by cash as well as with tokens, cards, keys or by credit card (in countries where this service is available)
- Change is given Keys, cards, or tokens (associated with a service) dispensing
- Barcode scanning for an automated management of promotions, bonuses and discounts
- Incentive to purchase a program of higher price/quality to increase sales
- Possibility to print limited time promotional tickets to increase the frequency of visits
- Promotional campaign management through discounts and special offers
- Refund receipt in the event of failed service provision or machine malfunction
- Differentiated pricing per payment method (cash or cashless)
- Alarm messages and accounting data via e-mail sending
- Automatic print of daily accounting reports by means of a special barcode
- Possibility to print or export of accounting data and marketing information in .csv format
- Direct phone calls through a dedicated line (optional)

Installed peripheral devices

- RM5 HD electronic coin mechanism
- Barcode and QR code scanner
- Thermal receipt printer

Optional peripheral devices

- NV9 USB banknote reader
- Evolution hopper
- 2nd Evolution hopper
- EuroKey Next cashless system
- Card dispenser
- Key dispenser
- Telephone call kit for dedicated line
- POS module (available in the countries that use it)

Tools

TouchConfig
Innovative integrated program suitable for a complete starter configuration, which allows the importing and exporting of total and partial accounting data

TouchCompta
Program suitable for consulting, analysing, exporting and printing machine accounting data. Possibility to set search filters to obtain all the statistics linked to marketing operations. Data access is controlled and protected by hierarchical passwords

Technical Schematics

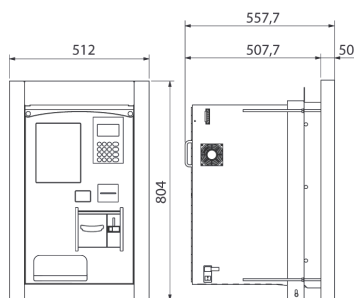
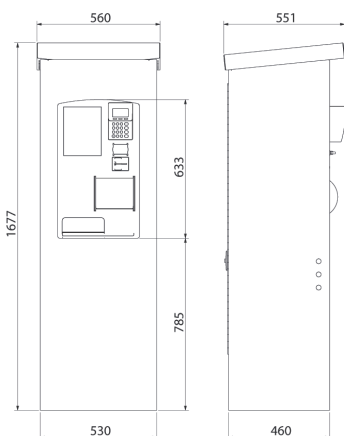

Note: Unit of measure mm

Technical specifications

| | Accessible cabinet-mounted starter | Wall-mounted starter |
|-----------------------|--|--|
| Dimensions (LxHxD) | 560 x 1.677 x 551 mm | 512 x 804 x 562,7 mm |
| Weight | 81 Kg | 53 Kg |
| Supply voltage | 230 Vac | 230 Vac |
| Current consumption | 230 VA | 230 VA |
| Operating temperature | -15 °C - 50 °C humidity 10% - 90% uncondensed | -15 °C - 50 °C humidity 10% - 90% uncondensed |

Internet connection required to guarantee the proper functioning of the starter

Coin capacity

| | 0.5 € | 1 € | 2 € |
|--------------------|-------|-------|-------|
| 1 Evolution hopper | 1,500 | 1,500 | 1,200 |
| 2 Evolution hopper | 3,000 | 3,000 | 2,400 |